



# KiDS ROCK!

child care center

A community-based childcare center will fill a critical role in the social infrastructure of a healthy community, allowing children, families, businesses, and communities to thrive.



Established in 2020 as a non-profit organization, **KiDs ROCK!** was created for the purpose of operating a community-based childcare center to address the need for additional childcare services in Luverne and Rock County.

## OUR MISSION

- what we do -

Build a rock-solid foundation that prepares children to thrive socially, emotionally and academically.

## OUR VISION

- where we're going -

We invest in children for the future of our communities.



## current childcare SHORTAGE

**550-570**

total number of children age 5 and under in Rock County

**360-370**

children under age 5 with working parents

**240**

current licensed child care capacity within Rock County

**120-130**

licensed child care spots needed for children ages 0-5

## GIVING OPPORTUNITIES

**KiDs ROCK!** is partnering with the Luverne Area Community Foundation to assist in accepting charitable gifts on our behalf.

- Giving Heart - - - - - \$ 100,000
- Shooting Star - - - - - \$ 50,000
- Building Block - - - - - \$ 25,000
- Rainbow - - - - - \$ 10,000
- Imagination - - - - - \$ 5,000
- Lullaby - - - - - \$ 2,500
- Friendship - - - - - \$ 1,000
- Other - - - - - Any Amount

All donations \$1000 and above will be recognized on a permanent Donor Board within the facility.

\* Checks payable to LACF  
102 E Main St., Luverne, MN 56156

I am interested in pledging my donation over \_\_\_ years

Name \_\_\_\_\_

Address \_\_\_\_\_

Phone \_\_\_\_\_

Email \_\_\_\_\_

The Luverne Area Community Foundation has several special gift options available—such as donating gifts of grain or stocks—to make donating to our fundraiser easy and seamless.

I am interested in a special gift option and I'd like more information from LACF.

## WHY NOW?

The shortage of licensed childcare slots in Luverne and Rock County negatively impacts families, businesses and community development.

When a **family** cannot find child care, they are forced to make difficult choices about where they live, where they work, and when they conceive.

When a **business** looks to attract a workforce, quality child care and education are essential to employee recruitment.

When a **community** aspires to grow, child care is essential. A lack of it directly impacts housing and jobs.

By securing a **\$2.6 million grant from the United States Department of Agriculture**, the City of Luverne has already begun the process of building Rock County's largest child care facility.

But we still need your help.

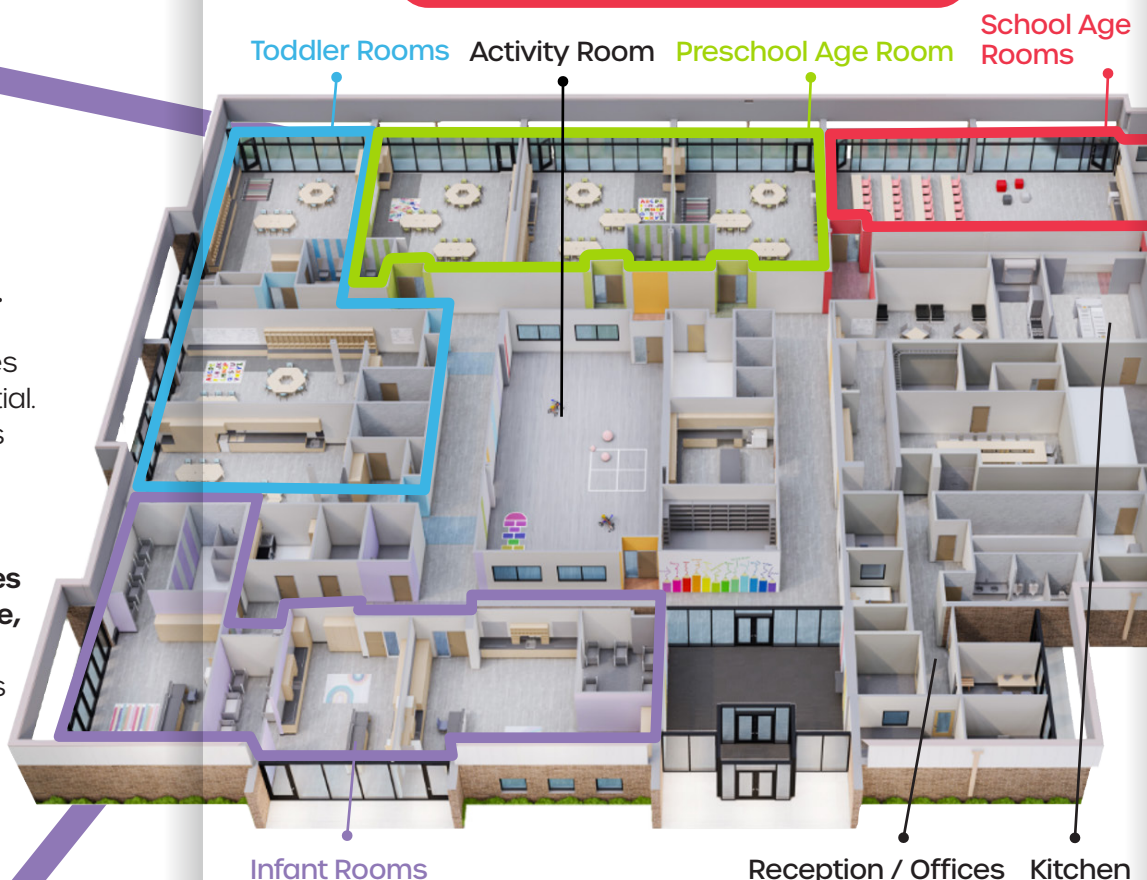





Established in 2020 as a non-profit organization, **KiDS ROCK!** was created for the purpose of operating a community-based childcare center to address the need for additional childcare services in Luverne and Rock County.

## OUR MISSION

- what we do -

Build a rock-solid foundation that prepares children to thrive socially, emotionally and academically.

## OUR VISION

- where we're going -

We invest in children for the future of our communities.



## current childcare SHORTAGE

**550-570**

total number of children age 5 and under in Rock County

**360-370**

children under age 5 with working parents

**240**

current licensed child care capacity within Rock County

**120-130**

licensed child care spots needed for children ages 0-5

## THE PROJECT

**KiDS ROCK!** is partnering with the City of Luverne to create a licensed child care center at 1 Roundwind Road in Luverne that will provide care for

**186 KIDS**

the new center will:

- Accommodate care for **24 infants, 42 toddlers, 60 preschoolers, and 60 school age children.**
- Include **11 classrooms**, a gym, a commercial kitchen, office and staff support spaces, a conference room, restrooms, nursing rooms, laundry and storage rooms, and outdoor playgrounds.
- Feature **safety, security, and technology improvements**, an improved parking lot for efficient drop-off and pick-up, new plumbing and HVAC throughout the facility, and a new roof.
- Meet all indoor and outdoor space needs as required by the Minnesota Department of Human Services.

**\$7** invested in early childhood yields a **\$17 RETURN**



## WHY NOW?

The shortage of licensed childcare slots in Luverne and Rock County negatively impacts families, businesses and community development.

When a **family** cannot find child care, they are forced to make difficult choices about where they live, where they work, and when they conceive.

When a **community** aspires to grow, child care is essential. A lack of it directly impacts housing and jobs.

When a **business** looks to attract a workforce, quality child care and education are essential to employee recruitment.

By securing a **\$2.6 million grant from the United States Department of Agriculture**, the City of Luverne has already begun the process of building Rock County's largest child care facility.

But we still need your help.

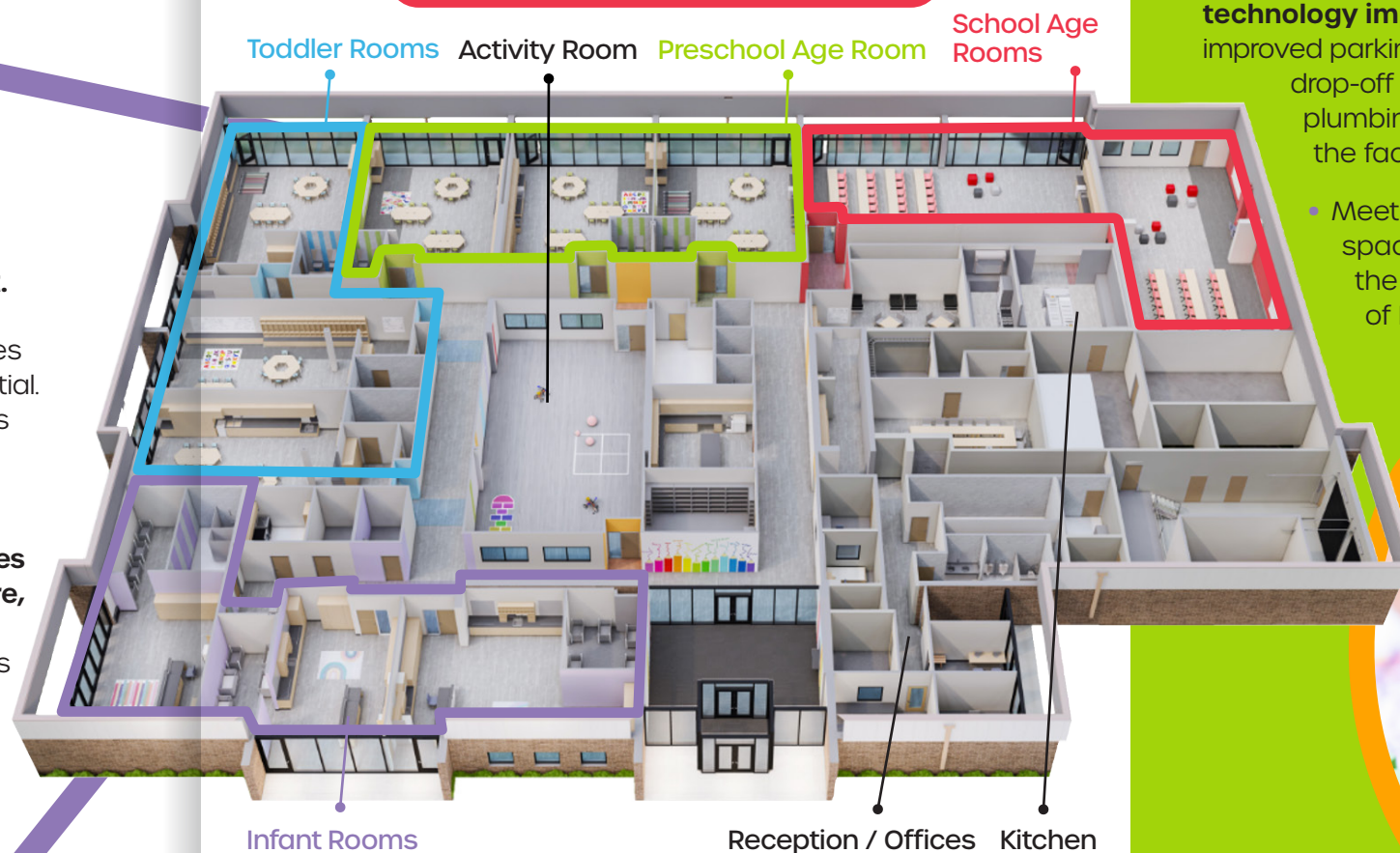



# GIVING OPPORTUNITIES

**KiDS ROCK!** is partnering with the Luverne Area Community Foundation to assist in accepting charitable gifts on our behalf.

- Giving Heart - - - - - \$ 100,000
- Shooting Star - - - - - \$ 50,000
- Building Block - - - - - \$ 25,000
- Rainbow - - - - - \$ 10,000
- Imagination - - - - - \$ 5,000
- Lullaby - - - - - \$ 2,500
- Friendship - - - - - \$ 1,000
- Other - - - - - Any Amount

All donations \$1000 and above will be recognized on a permanent Donor Board within the facility.

\* Checks payable to LACF  
102 E Main St., Luverne, MN 56156

I am interested in pledging my donation over \_\_\_ years

Name \_\_\_\_\_

Address \_\_\_\_\_

Phone \_\_\_\_\_

Email \_\_\_\_\_

The Luverne Area Community Foundation has several special gift options available—such as donating gifts of grain or stocks—to make donating to our fundraiser easy and seamless.

I am interested in a special gift option and I'd like more information from LACF.

Our goal is to raise

# \$1,000,000

for the following:

- Cribs & Cots
- High chairs, Tables, Desks, Chairs, Stools, & Flexible Seating
- Rugs / Carpet
- Strollers & Wagons
- Balls & Toys for Activity Room
- Outdoor Playground Equipment
- Trikes & Scooters
- Interior remodeling
- Commercial Kitchen & Equipment
- Office Equipment
- Items for Block Play, Gross Motor, Dramatic Play, Nonmobile Play, Manipulatives, Library, Music, Art, Science & Sensory Exploration as per MN DHS Requirements



remodeling budget  
**\$6,300,000**

The City of Luverne is committed to:

- Owning the building
- Remodeling the space
- Leasing the building to Kids Rock! Nonprofit for \$1/year
- Sustaining operations through annual financial support and in-kind contributions

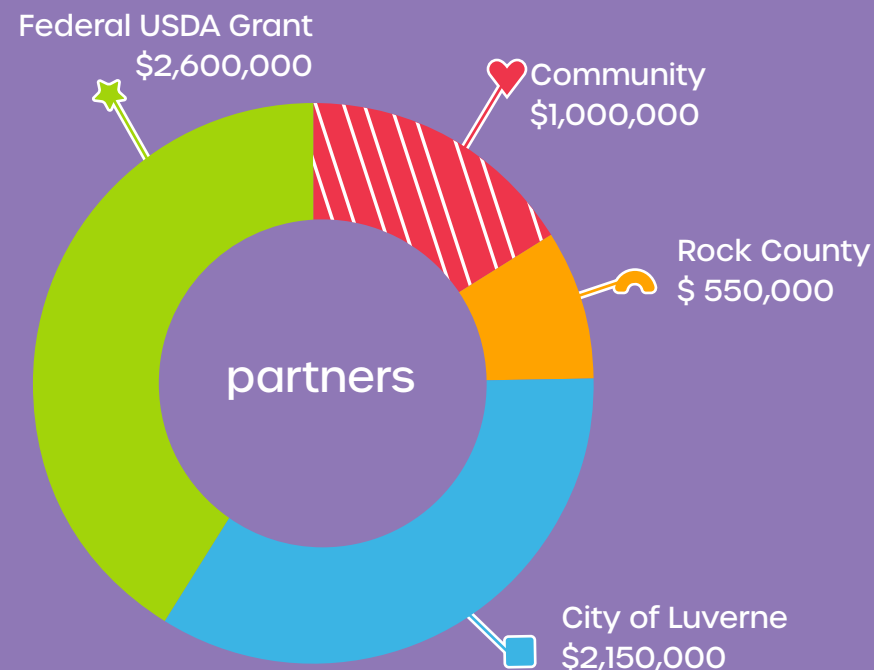

# KiDS ROCK!

## child care center

A community-based childcare center will fill a critical role in the social infrastructure of a healthy community, allowing children, families, businesses, and communities to thrive.